

CONRAD J. DeSANTIS
Business & Real Estate
Also Admitted in Pennsylvania

TIMOTHY W. GASKILL
Business, Probate
Family Litigation

DONALD R. SMITH
Personal Injury & Wrongful Death
Commercial Litigation

CURTIS L. SHENKMAN
Board Certified
Real Estate Attorney

BROOKE GROGAN
Attorney



DeSANTIS, GASKILL, SMITH & SHENKMAN, P.A.

ATTORNEYS & COUNSELORS AT LAW

ESTABLISHED 1973

11891 U.S. HIGHWAY ONE, SUITE100
NORTH PALM BEACH, FLORIDA 33408

TELEPHONE (561) 622-2700 FACSIMILE (561) 622-2841

www.LawPalmBeach.com

LEGAL ASSISTANTS
CIVIL TRIAL, PROBATE
AND FAMILY LAW
KAREN M. BOYDEN-LOPATOSKY
MINDY VASSER

PERSONAL INJURY
ROBIN B. MODLIN, CP
TERRI L. VLASSICK

REAL ESTATE
JUDY D. MONTEIRO
DENISE B. PAOLUCCI

February 11, 2016

Sent by email

D. Albery Arrington, PhD., Executive Director
Clint Yerkes, Deputy Executive Director
Loxahatchee River Environmental Control District
2500 Jupiter Drive
Jupiter, Florida 33458-8964

Re: Initial Resolution for **TURTLE CREEK SUBSYSTEM 3** Assessment Area

Dear Dr. Arrington and Mr. Yerkes:

Per your request, please attach to this letter the Pending Lien Notice, Notice of Intent to Assess, Resolution 2016-12, the PROPOSED "Exhibit B Description of Improvements", "Exhibit B Map of the Assessment Area", and preliminary List of Property Owners.

A **SUGGESTED MOTION** for the Board to consider is:

"THAT THE GOVERNING BOARD approve Resolution 2016-12 the NOTICE OF INTENT to Assess, the Pending Lien Notice, and the Exhibits for the **TURTLE CREEK SUBSYTEM 3** Assessment Area."

I will bring the originals to be signed at the Governing Board meeting. Thereafter the District will record in the Public Records.

Sincerely,

Curtis L. Shenkman

Curtis L. Shenkman

RETURN TO: WC-53
Curtis L. Shenkman, Esquire
DeSantis, Gaskill, Smith & Shenkman, P.A.
11891 U.S. Highway One
North Palm Beach, Florida 33408

PENDING LIEN NOTICE
TURTLE CREEK SUBSYSTEM 3 ASSESSMENT AREA

THE LOXAHATCHEE RIVER ENVIRONMENTAL CONTROL DISTRICT, a special district of the State of Florida, created in 1971 and existing pursuant to Chapter 2002-358, Laws of Florida (hereinafter referred to as the "District", hereby clarifies the lien status of the "Notice of Intent to Assess" attached hereto and made a part hereof (referred to as the "Pending Lien").

The Pending Lien shall not be considered certified, confirmed or ratified until such time as the passage of the Final Assessment Roll Resolution of the District.

The intention of the District in publishing this Pending Lien Notice is to assist the property owners who may be selling or refinancing their property and parties who may be placing a mortgage on their property to do so knowing that the District is not seeking the payment of any funds on the Pending Lien until the non-ad valorem tax bill is issued for the property on the date set forth in the Final Assessment Roll Resolution of the District.

Any inquiries as to the Pending Lien and the timing for the Final Assessment Roll Resolution and payment of said special assessments should be directed to:

LOXAHATCHEE RIVER ENVIRONMENTAL CONTROL DISTRICT
2500 Jupiter Park Drive
Jupiter, Florida 33458
Phone: (561) 747-5700

IN WITNESS WHEREOF, the undersigned, Executive Director of the Loxahatchee River Environmental Control District, herein certifies that on this 18th day of FEBRUARY, 2016, the information contained herein is true and accurate.

WITNESSES:

LOXAHATCHEE RIVER ENVIRONMENTAL
CONTROL DISTRICT

By: _____
D. Albrey Arrington, Ph.D.
EXECUTIVE DIRECTOR

STATE OF FLORIDA
COUNTY OF PALM BEACH

The foregoing instrument was acknowledged before me this 18th day of February, 2016, by D. Albrey Arrington, EXECUTIVE DIRECTOR of the LOXAHATCHEE RIVER ENVIRONMENTAL CONTROL DISTRICT, a special district of the State of Florida, on behalf of the District, personally known to me.

(NOTARY SEAL)

NOTARY PUBLIC, STATE OF FLORIDA

Special/Assessment/PendingLienNotice

RETURN TO: WC-53
Curtis L. Shenkman, Esquire
DeSantis, Gaskill, Smith & Shenkman, P.A.
11891 U.S. Highway One
North Palm Beach, Florida 33408

**NOTICE OF INTENT TO ASSESS
TURTLE CREEK SUBSYSTEM 3 ASSESSMENT AREA**

THE LOXAHATCHEE RIVER ENVIRONMENTAL CONTROL DISTRICT, a special district of the State of Florida (the “District”) **created in 1971 and existing pursuant to Chapter 2002-358, Laws of Florida**, (the “Act”), hereby gives public notice that the District’s Governing Board on the 18th day of February, 2016, passed Resolution **2016-12**, authorizing the construction of certain local sewer improvements as further described in said Resolution **2016-12**, which is attached hereto as Exhibit “A”. It is the intent of the District to assess the owners of property specially benefited by such sewer improvements, which property is further described on the attached **Exhibit “B”**, and to apportion the District’s costs for the total expenses related to the design and construction of said improvements, based upon each owner’s proportionate share of said costs determined upon a square footage basis, or by other methods as the Governing Board may deem fair and equitable, pursuant to the Act and Rules of the District, as same may be amended from time to time hereafter.

Any inquiries to the District’s progress in completing certification of said assessments should be directed to:

LOXAHATCHEE RIVER ENVIRONMENTAL CONTROL DISTRICT
2500 Jupiter Park Drive
Jupiter, Florida 33458

IN WITNESS WHEREOF, the undersigned, Executive Director of the Loxahatchee River Environmental Control District, hereby certifies on this 18th day of FEBRUARY, 2016, that the information contained herein is true and accurate.

WITNESSES:

D. Albrey Arrington
Executive Director

STATE OF FLORIDA
COUNTY OF PALM BEACH

SWORN TO and subscribed before me this 18th day of February, 2016, by D. Albrey Arrington, EXECUTIVE DIRECTOR of the LOXAHATCHEE RIVER ENVIRONMENTAL CONTROL DISTRICT, who is personally known to me.

(NOTARY SEAL)

NOTARY PUBLIC, STATE OF FLORIDA

Special/Assessment/NoticeIntentToAssess

RESOLUTION 2016-12

A RESOLUTION OF THE LOXAHATCHEE RIVER ENVIRONMENTAL CONTROL DISTRICT RELATING TO **TURTLE CREEK SUBSYSTEM 3** ASSESSMENT AREA IMPROVEMENTS IN ACCORDANCE WITH DISTRICT RULE 31-11; STATING THE NATURE OF THE PROPOSED IMPROVEMENTS; DESIGNATING THE STREETS TO BE IMPROVED; DESIGNATING THAT PLANS, SPECIFICATIONS, AND A TENTATIVE APPORTIONMENT BE PREPARED; PROVIDING FOR THE AVAILABILITY OF PLANS AND SPECIFICATIONS AND FOR THE PREPARATION OF THE PRELIMINARY SPECIAL ASSESSMENT ROLL; PROVIDING FOR DECLARING LINE AVAILABLE FOR CONNECTION; PROVIDING FOR CONSISTENCY; PROVIDING FOR SEVERABILITY; PROVIDING AN EFFECTIVE DATE.

WHEREAS, the Governing Board of the Loxahatchee River Environmental Control District (hereinafter called the "District") has considered the need for improvements to the **TURTLE CREEK SUBSYSTEM 3** Assessment Area (the "Area") in Martin County, Florida;

WHEREAS the District shall construct and declare available sewerage collection lines and related appurtenances comprising a localized District sewer system in the Area as an Established Residential Neighborhood based upon the Governing Board's determination of any of the following:

- (1) n/a; or
- (2) that a reasonable alternative to the septic tanks exists for the treatment of the sewerage, taking into consideration factors such as cost; or
- (3) the discharge from the septic tanks is adversely affecting the health of the user or the public, or the groundwater or surface water is degraded; or
- (4) to enhance the environmental and scenic value of surface waters.

WHEREAS, the Governing Board has considered the facts, evidence, and presentations of the District Engineer, District staff and consultants as to the need for sanitary sewers in the Area and considered such recommendations to be in accordance with the above referenced Criteria of the "Ellis Rule" as well as in the best interests of the citizens of the District and the citizens of this Area.

NOW, THEREFORE, BE IT RESOLVED BY THE GOVERNING BOARD OF THE DISTRICT, THAT:

Section 1. Title:

This Resolution shall be known as the Resolution Authorizing the Project known as "**TURTLE CREEK SUBSYSTEM 3** Assessment Area Improvements".

Section 2. Nature of Improvements:

The project improvements shall consist of the construction of a waste water and sewage system within lands under the jurisdiction of the District. The proposed improvements performed shall generally consist of those set forth on Composite Exhibit "B".

Section 3. Designation of Streets to be Improved:

The streets included within the **TURTLE CREEK SUBSYSTEM 3** Assessment Area Improvements are set forth on Composite Exhibit "B".

Section 4. Plans, Specifications and Tentative Apportionment:

Upon adoption of this Resolution, The District Engineers and staff shall prepare plans, specifications and estimated total costs of such proposed improvements, together with a tentative apportionment of such costs between the District and individual parcels of property receiving special benefits pursuant to the improvements.

Section 5. Public Inspection:

The Plans, Specifications and tentative apportionments for the **TURTLE CREEK SUBSYSTEM 3** Assessment Area Improvements shall be available for inspection in the Office of the

Executive Director, Loxahatchee River Environmental Control District, 2500 Jupiter Park Drive, Jupiter, Florida 33458. The District's Engineer shall make available said plans and specifications prepared incident thereto, for inspection in the Office of the District's Engineer.

Section 6. Assessment Roll:

The District Clerk is directed to prepare a Preliminary Assessment Roll based upon this Resolution, District Rule 31-11, and the District Engineer's tentative apportionment, and to make publication of notice in newspapers in Martin and Palm Beach Counties, together with notice mailed to those interested parties and affected property owners requesting such in writing, in accordance with the requirements of District Rule 31-11.

Section 7. Availability for Connection and Required Connection:

The waste water and sewerage system shall be "Available" for connection in accordance with District Rule 31-3.003(3) and Florida Statutes 381.0065(2)(a) when the Florida Department of Health releases the system for service, which is the date of actual "Availability". In accordance with Florida Statutes 381.00655, the affected property owners shall be required to connect to the sewerage system within one (1) year of the actual Availability.

Section 8. All Resolutions or parts of Resolutions in conflict herewith are hereby repealed to the extent of such conflict.

Section 9. In the event that any portion of this Resolution is found to be unconstitutional or improper, it shall be severed herefrom and shall not affect the validity of the remaining portions of this Resolution.

Section 10. This Resolution shall become effective upon its passage and adoption.

PASSED AND ADOPTED BY THE GOVERNING BOARD OF THE LOXAHATCHEE RIVER ENVIRONMENTAL CONTROL DISTRICT, THIS 18th DAY OF FEBRUARY, 2016.

LOXAHATCHEE RIVER ENVIRONMENTAL CONTROL DISTRICT
VOTE

GORDON M. BOGGIE, Chairman

STEPHEN ROCKOFF

HARVEY M. SILVERMAN

JAMES D. SNYDER

DR. MATT H. ROSTOCK

EXHIBIT "B"

TURTLE CREEK - SUBSYSTEM 3

SEWER SYSTEM ASSESSMENT AREA

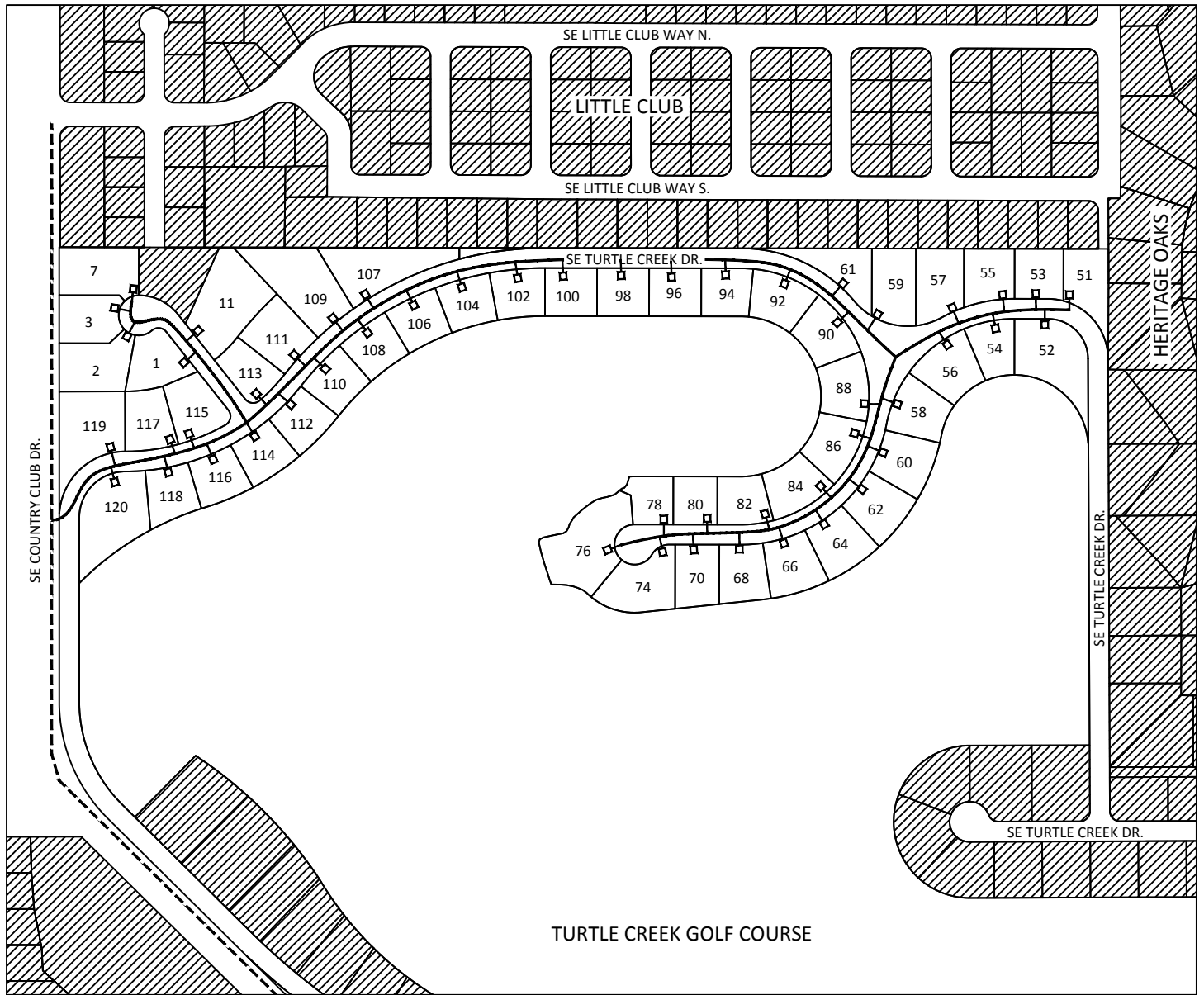

LEGEND

- NOT IN ASSESSMENT AREA
- EXISTING 6" FORCE MAIN
- PROPOSED 2" FORCE MAIN
- PROPOSED LP SEWER SERVICE

MARTIN COUNTY, FLORIDA

EXHIBIT “B”

PROPOSED SEWER SERVICE ASSESSMENT AREA

TURTLE CREEK SUBSYSTEM 3 ASSESSMENT AREA

The properties to be provided sewer service are located within Section 22, Township 40 South, Range 42 East, Unincorporated Martin County, Florida and lies within the following general boundaries:

- On the North by Little Club Subdivision;
- On the South by Turtle Creek Golf Course;
- On the East by Heritage Oaks Subdivision; and
- On the West by SE Country Club Drive.

The approximate quantity of materials required to complete the project are:

- 4,410 Lineal Feet 2” Low Pressure Sewer Lines
- 52 Service Connections
- 52 Low Pressure Pumping Units
- 3 Terminal Flushing Ports
- 9 Inline Flushing Ports

Mr. & Mrs. Larry Viens
re: 52 SE Turtle Creek Dr
PO Box 7359
Jupiter FL 33468
22-40-42-015-001-00010-1

Mr. & Mrs. Arthur Lahr
re: 54 SE Turtle Creek Dr
54 SE Turtle Creek Dr
Tequesta FL 33469
22-40-42-015-001-00020-9

Mr. & Mrs. Richard Tessaro
re: 56 SE Turtle Creek Dr
56 SE Turtle Creek Dr
Tequesta FL 33469
22-40-42-015-001-00030-7

Mr. & Mrs. William Hawkins
re: 58 SE Turtle Creek Dr
58 SE Turtle Creek Dr
Tequesta FL 33469
22-40-42-015-001-00040-5

Ms. Carole Fambrini
re: 60 SE Turtle Creek Dr
60 SE Turtle Creek Dr
Tequesta FL 33469
22-40-42-015-001-00050-2

Mr. & Mrs. William Mc Nealy
re: 62 SE Turtle Creek Dr
62 SE Turtle Creek Dr
Tequesta FL 33469
22-40-42-015-001-00060-0

Mr. & Mrs. Stephen Wilgar
re: 64 SE Turtle Creek Dr
64 SE Turtle Creek Dr
Tequesta FL 33469
22-40-42-015-001-00070-8

Mr. & Mrs. Clement Springer
re: 66 SE Turtle Creek Dr
66 SE Turtle Creek Dr
Tequesta FL 33469
22-40-42-015-001-00080-6

Mr. & Mrs. Dennis Coffey
re: 68 SE Turtle Creek Dr
68 SE Turtle Creek Dr
Tequesta FL 33469
22-40-42-015-001-00090-4

D Greene/S Johnson
re: 70 SE Turtle Creek Dr
70 SE Turtle Creek Dr
Tequesta FL 33469
22-40-42-015-001-00100-2

Mr. & Mrs. Edwin Frost
re: 74 SE Turtle Creek Dr
74 SE Turtle Creek Dr
Tequesta FL 33469
22-40-42-015-001-00110-0

Ms. Mary Larizza
re: 76 SE Turtle Creek Dr
76 SE Turtle Creek Dr
Tequesta FL 33469
22-40-42-015-001-00120-8

Mr. & Mrs. Fred Ash
re: 78 SE Turtle Creek Dr
78 SE Turtle Creek Dr
Tequesta FL 33469
22-40-42-015-001-00140-4

Mr. & Mrs. David Wales
re: 80 SE Turtle Creek Dr
80 SE Turtle Creek Dr
Tequesta FL 33469
22-40-42-015-001-00150-1

Mr. Lew Rumsmoke
re: 82 SE Turtle Creek Dr
82 SE Turtle Creek Dr
Tequesta FL 33469
22-40-42-015-001-00160-9

Mr. & Mrs. Anton Greaton
re: 84 SE Turtle Creek Dr
84 SE Turtle Creek Dr
Tequesta FL 33469
22-40-42-015-001-00170-7

Mr. & Mrs. John Maentanis
re: 86 SE Turtle Creek Dr
5337 Fairview
Skokie IL 60077
22-40-42-015-001-00180-5

B Vankat/V Goger
re: 88 SE Turtle Creek Dr
305 Baltimore Ave
Pt Pleasant Bch NJ 08742
22-40-42-015-001-00190-3

Mr. & Mrs. Ronald Harrison
re: 90 SE Turtle Creek Dr
PO Box 221
Orleans MA 02643
22-40-42-015-001-00200-1

Mr. & Mrs. John Andersen
re: 92 SE Turtle Creek Dr
92 SE Turtle Creek Dr
Tequesta FL 33469
22-40-42-015-001-00210-9

Mr. & Mrs. Lawrence Magar
re: 94 SE Turtle Creek
94 SE Turtle Creek
Tequesta FL 33469
22-40-42-015-001-00220-7

Mr. & Mrs. Douglas Knowles
re: 96 SE Turtle Creek Dr
13 Saddleback Rd
Tequesta FL 33469
22-40-42-015-001-00230-5

Mr. & Mrs. Arthur Hanoian
re: 98 SE Turtle Creek Dr
98 SE Turtle Creek Dr
Tequesta FL 33469
22-40-42-015-001-00240-3

Mr. Mark Sedelnik
re: 100 SE Turtle Creek Dr
100 SE Turtle Creek Dr
Tequesta FL 33469
22-40-42-015-001-00250-0

Ms. Dorothy Koteski
re: 102 SE Turtle Creek Dr
27 Cooper Run Dr
Cherry Hill NJ 08003
22-40-42-015-001-00260-8

Mr. & Mrs. Frank Horgan
re: 104 SE Turtle Creek Dr
180 Park Ave
Centerville MA 02632
22-40-42-015-001-00270-6

Mr. & Mrs. Christopher Housen
re: 106 SE Turtle Creek Dr
403 1/2 Osprey Pt Dr
Brielle NJ 08730
22-40-42-015-001-00280-4

Mr. & Mrs. Robert Hendrickson
re: 108 SE Turtle Creek Dr
108 SE Turtle Creek Dr
Tequesta FL 33469
22-40-42-015-001-00290-2

Mr. & Mrs. James Scott
re: 110 SE Turtle Creek Dr
110 SE Turtle Creek Dr
Tequesta FL 33469
22-40-42-015-001-00300-0

Mr. & Mrs. Arthur Fritz
re: 112 SE Turtle Creek Dr
112 SE Turtle Creek Dr
Tequesta FL 33469
22-40-42-015-001-00310-8

Mr. & Mrs. John Sullivan
re: 114 SE Turtle Creek Dr
114 SE Turtle Creek Dr
Tequesta FL 33469
22-40-42-015-001-00320-6

Ms. Adelor Warren
re: 116 SE Turtle Creek Dr
116 SE Turtle Creek Dr
Tequesta FL 33469
22-40-42-015-001-00330-4

Mr. & Mrs. Richard Greisch
re: 118 SE Turtle Creek Dr
402 Reserve Trl
Chagrin Falls OH 44022
22-40-42-015-001-00340-2

Mr. & Mrs. Peter Holcomb
re: 120 SE Turtle Creek Dr
120 SE Turtle Creek Dr
Tequesta FL 33469
22-40-42-015-001-00350-9

Mr. & Mrs. Janis Partlow
re: 51 SE Turtle Creek Dr
112 E Coral Fish Ln
Jupiter FL 33477
22-40-42-015-002-00010-9

Mr. Patrick Cicalese
re: 53 SE Turtle Creek Dr
53 SE Turtle Creek Dr
Tequesta FL 33469
22-40-42-015-002-00020-7

Mr. Roger Buckwalter
re: 55 SE Turtle Creek Dr
48 Wingo St
Tequesta FL 33469
22-40-42-015-002-00030-5

Mr. & Mrs. Harry Fry Jr
re: 57 SE Turtle Creek Dr
57 SE Turtle Creek Dr
Tequesta FL 33469
22-40-42-015-002-00040-3

Ms. Patricia Millman
re: 59 SE Turtle Creek Dr
59 SE Turtle Creek Dr
Tequesta FL 33469
22-40-42-015-002-00050-0

F Latimer/C Colitz
re: 61 SE Turtle Creek Dr
61 SE Turtle Creek Dr
Tequesta FL 33469
22-40-42-015-002-00060-8

Ms. Tania Rosello
re: 107 SE Turtle Creek Dr
107 SE Turtle Creek Dr
Tequesta FL 33469
22-40-42-015-003-00010-7

Mr. & Mrs. Sam Van Sickle
re: 109 SE Turtle Creek Dr
109 SE Turtle Creek Dr
Tequesta FL 33469
22-40-42-015-003-00020-5

Ms. Pauline Brociner
re: 111 SE Turtle Creek Dr
111 SE Turtle Creek Dr
Tequesta FL 33469
22-40-42-015-003-00030-3

Mr. & Mrs. Ronald Johnson
re: 113 SE Turtle Creek Dr
113 SE Turtle Creek Dr
Tequesta FL 33469
22-40-42-015-003-00040-1

Mr. & Mrs. Jerold Miller
re: 115 SE Turtle Creek Dr
115 SE Turtle Creek Dr
Tequesta FL 33469
22-40-42-015-003-00050-8

Ms. Geraldine Gardner
re: 117 SE Turtle Creek Dr
117 SE Turtle Creek Dr
Tequesta FL 33469
22-40-42-015-003-00060-6

Mr. & Mrs. Anthony Interdonato
re: 119 SE Turtle Creek Dr
119 SE Turtle Creek Dr
Tequesta FL 33469
22-40-42-015-003-00070-4

Mr. & Mrs. Forest Padon
re: 1 SE Loggerhead Ln
1 SE Loggerhead Ln
Tequesta FL 33469
22-40-42-015-003-00080-2

Mr. & Mrs. John Rice
re: 2 SE Loggerhead Ln
2 SE Loggerhead Ln
Tequesta FL 33469
22-40-42-015-003-00090-0

Mr. & Mrs. John Bachman
re: 3 SE Loggerhead Ln
3 SE Loggerhead Ln
Tequesta FL 33469
22-40-42-015-003-00100-8

Ms. Kathleen Jennings
re: 7 SE Loggerhead Ln
7 SE Loggerhead Ln
Tequesta FL 33469
22-40-42-015-003-00110-6

Ms. Catherine Von Paul
re: 11 SE Loggerhead Ln
11 SE Loggerhead Ln
Tequesta FL 33469
22-40-42-015-003-00130-2