

**CONRAD J. DeSANTIS**  
*Business & Real Estate*  
Also Admitted in Pennsylvania

**TIMOTHY W. GASKILL**  
*Business, Probate*  
*Family Litigation*

**DONALD R. SMITH**  
*Personal Injury & Wrongful Death*  
*Commercial Litigation*

**CURTIS L. SHENKMAN**  
*Board Certified*  
*Real Estate Attorney*

**BROOKE GROGAN**  
*Attorney*



**DESANTIS, GASKILL, SMITH & SHENKMAN, P.A.**

**ATTORNEYS & COUNSELORS AT LAW**

**ESTABLISHED 1973**

11891 U.S. HIGHWAY ONE, SUITE 100  
NORTH PALM BEACH, FLORIDA 33408  
TELEPHONE (561) 622-2700 FACSIMILE (561) 622-2841

[www.LawPalmBeach.com](http://www.LawPalmBeach.com)

**LEGAL ASSISTANTS**  
**CIVIL TRIAL, PROBATE**  
**AND FAMILY LAW**  
KAREN M. BOYDEN-LOPATOSKY  
MINDY VASSER  
**PERSONAL INJURY**  
ROBIN B. MODLIN, CP  
TERRI L. VLASSICK  
**REAL ESTATE**  
JUDY D. MONTEIRO  
DENISE B. PAOLUCCI

January 12, 2016

Sent by email

D. Albery Arrington, PhD., Executive Director  
Clint Yerkes, Deputy Executive Director  
Loxahatchee River Environmental Control District  
2500 Jupiter Drive  
Jupiter, Florida 33458-8964

Re: Initial Resolution for **10828 Whispering Pines Trl** Assessment Area

Dear Dr. Arrington and Mr. Yerkes:

Per your request, please attach to this letter the Pending Lien Notice, Notice of Intent to Assess, Resolution 2016-05 (Exhibit A), the proposed "Description of Improvements", "Map of the Assessment Area", and List of Property Owners (composite Exhibit B).

A **SUGGESTED MOTION** for the Board to consider is:

"THAT THE GOVERNING BOARD approve Resolution **2016-05** the NOTICE OF INTENT To Assess, the Pending Lien Notice, and the Exhibits for the **10828 Whispering Pines Trl** Assessment Area."

I will bring the originals to be signed at the Governing Board meeting. Thereafter the LRD will record in the Public Records.

Sincerely,

*Curtis L. Shenkman*

Curtis L. Shenkman

RETURN TO: WC-53  
Curtis L. Shenkman, Esquire  
DeSantis, Gaskill, Smith & Shenkman, P.A.  
11891 U.S. Highway One  
North Palm Beach, Florida 33408

**PENDING LIEN NOTICE**  
**10828 WHISPERING PINES TRL. ASSESSMENT AREA**

THE LOXAHATCHEE RIVER ENVIRONMENTAL CONTROL DISTRICT, a special district of the State of Florida, created in 1971 and existing pursuant to Chapter 2002-358, Laws of Florida (hereinafter referred to as the "District", hereby clarifies the lien status of the "Notice of Intent to Assess" attached hereto and made a part hereof (referred to as the "Pending Lien").

**The Pending Lien shall not be considered certified, confirmed or ratified until such time as the passage of the Final Assessment Roll Resolution of the District.**

**The intention of the District in publishing this Pending Lien Notice is to assist the property owners who may be selling or refinancing their property and parties who may be placing a mortgage on their property to do so knowing that the District is not seeking the payment of any funds on the Pending Lien until the non-ad valorem tax bill is issued for the property on the date set forth in the Final Assessment Roll Resolution of the District.**

Any inquiries as to the Pending Lien and the timing for the Final Assessment Roll Resolution and payment of said special assessments should be directed to:

LOXAHATCHEE RIVER ENVIRONMENTAL CONTROL DISTRICT  
2500 Jupiter Park Drive  
Jupiter, Florida 33458  
Phone: (561) 747-5700

IN WITNESS WHEREOF, the undersigned, Executive Director of the Loxahatchee River Environmental Control District, herein certifies that on this 21<sup>st</sup> day of JANUARY, 2016, the information contained herein is true and accurate.

WITNESSES: LOXAHATCHEE RIVER ENVIRONMENTAL CONTROL DISTRICT

\_\_\_\_\_  
\_\_\_\_\_

By: \_\_\_\_\_  
D. Albrey Arrington, Ph.D.  
EXECUTIVE DIRECTOR

STATE OF FLORIDA  
COUNTY OF PALM BEACH

The foregoing instrument was acknowledged before me this 21<sup>st</sup> day of January, 2016, by D. Albrey Arrington, EXECUTIVE DIRECTOR of the LOXAHATCHEE RIVER ENVIRONMENTAL CONTROL DISTRICT, a special district of the State of Florida, on behalf of the District, personally known to me.

(NOTARY SEAL)

\_\_\_\_\_  
NOTARY PUBLIC, STATE OF FLORIDA

Special/Assessment/PendingLienNotice

RETURN TO: WC-53  
Curtis L. Shenkman, Esquire  
DeSantis, Gaskill, Smith & Shenkman, P.A.  
11891 U.S. Highway One  
North Palm Beach, Florida 33408

**NOTICE OF INTENT TO ASSESS  
10828 WHISPERING PINES TRL ASSESSMENT AREA**

**THE LOXAHATCHEE RIVER ENVIRONMENTAL CONTROL DISTRICT**, a special district of the State of Florida (the “District”) **created in 1971 and existing pursuant to Chapter 2002-358, Laws of Florida**, (the “Act”), hereby gives public notice that the District’s Governing Board on the 21<sup>st</sup> day of January, 2016, passed Resolution **2016-05**, authorizing the construction of certain local sewer improvements as further described in said Resolution **2016-05**, which is attached hereto as Exhibit “A”. It is the intent of the District to assess the owners of property specially benefited by such sewer improvements, which property is further described on the attached **Exhibit “B”**, and to apportion the District’s costs for the total expenses related to the design and construction of said improvements, based upon each owner’s proportionate share of said costs determined upon a square footage basis, or by other methods as the Governing Board may deem fair and equitable, pursuant to the Act and Rules of the District, as same may be amended from time to time hereafter.

Any inquiries to the District’s progress in completing certification of said assessments should be directed to:

LOXAHATCHEE RIVER ENVIRONMENTAL CONTROL DISTRICT  
2500 Jupiter Park Drive  
Jupiter, Florida 33458

**IN WITNESS WHEREOF**, the undersigned, Executive Director of the Loxahatchee River Environmental Control District, hereby certifies on this 21<sup>st</sup> day of JANUARY, 2016, that the information contained herein is true and accurate.

WITNESSES:

\_\_\_\_\_

\_\_\_\_\_  
D. Albrey Arrington  
Executive Director

STATE OF FLORIDA  
COUNTY OF PALM BEACH

SWORN TO and subscribed before me this 21<sup>st</sup> day of January, 2016, by D. Albrey Arrington, EXECUTIVE DIRECTOR of the LOXAHATCHEE RIVER ENVIRONMENTAL CONTROL DISTRICT, who is personally known to me.

(NOTARY SEAL)

\_\_\_\_\_  
NOTARY PUBLIC, STATE OF FLORIDA

Special/Assessment/NoticeIntentToAssess

## RESOLUTION 2016-05

A RESOLUTION OF THE LOXAHATCHEE RIVER ENVIRONMENTAL CONTROL DISTRICT RELATING TO **10828 WHISPERING PINES TRL.** ASSESSMENT AREA IMPROVEMENTS IN ACCORDANCE WITH DISTRICT RULE 31-11; STATING THE NATURE OF THE PROPOSED IMPROVEMENTS; DESIGNATING THE STREETS TO BE IMPROVED; DESIGNATING THAT PLANS, SPECIFICATIONS, AND A TENTATIVE APPORTIONMENT BE PREPARED; PROVIDING FOR THE AVAILABILITY OF PLANS AND SPECIFICATIONS AND FOR THE PREPARATION OF THE PRELIMINARY SPECIAL ASSESSMENT ROLL; PROVIDING FOR DECLARING LINE AVAILABLE FOR CONNECTION; PROVIDING FOR CONSISTENCY; PROVIDING FOR SEVERABILITY; PROVIDING AN EFFECTIVE DATE.

WHEREAS, the Governing Board of the Loxahatchee River Environmental Control District (hereinafter called the "District") has considered the need for improvements to the **10828 WHISPERING PINES TRL.** Assessment Area (the "Area") in Martin County, Florida;

WHEREAS the District shall construct and declare available sewerage collection lines and related appurtenances comprising a localized District sewer system in the Area as an Established Residential Neighborhood based upon the Governing Board's determination of any of the following:

- (1) n/a; or
- (2) that a reasonable alternative to the septic tanks exists for the treatment of the sewerage, taking into consideration factors such as cost; or
- (3) the discharge from the septic tanks is adversely affecting the health of the user or the public, or the groundwater or surface water is degraded; or
- (4) to enhance the environmental and scenic value of surface waters.

WHEREAS, the Governing Board has considered the facts, evidence, and presentations of the District Engineer, District staff and consultants as to the need for sanitary sewers in the Area and considered such recommendations to be in accordance with the above referenced Criteria of the "Ellis Rule" as well as in the best interests of the citizens of the District and the citizens of this Area.

NOW, THEREFORE, BE IT RESOLVED BY THE GOVERNING BOARD OF THE DISTRICT, THAT:

Section 1.      Title:

This Resolution shall be known as the Resolution Authorizing the Project known as "**10828 WHISPERING PINES TRL.** Assessment Area Improvements".

Section 2.      Nature of Improvements:

The project improvements shall consist of the construction of a waste water and sewage system within lands under the jurisdiction of the District. The proposed improvements performed shall generally consist of those set forth on Composite Exhibit "B".

Section 3.      Designation of Streets to be Improved:

The streets included within the **10828 WHISPERING PINES TRL.** Assessment Area Improvements are set forth on Composite Exhibit "B".

Section 4.      Plans, Specifications and Tentative Apportionment:

Upon adoption of this Resolution, The District Engineers and staff shall prepare plans, specifications and estimated total costs of such proposed improvements, together with a tentative apportionment of such costs between the District and individual parcels of property receiving special benefits pursuant to the improvements.

Section 5.      Public Inspection:

The Plans, Specifications and tentative apportionments for the **10828 WHISPERING PINES TRL.** Assessment Area Improvements shall be available for inspection in the Office of the Executive

Director, Loxahatchee River Environmental Control District, 2500 Jupiter Park Drive, Jupiter, Florida 33458. The District's Engineer shall make available said plans and specifications prepared incident thereto, for inspection in the Office of the District's Engineer.

Section 6. Assessment Roll:

The District Clerk is directed to prepare a Preliminary Assessment Roll based upon this Resolution, District Rule 31-11, and the District Engineer's tentative apportionment, and to make publication of notice in newspapers in Martin and Palm Beach Counties, together with notice mailed to those interested parties and affected property owners requesting such in writing, in accordance with the requirements of District Rule 31-11.

Section 7. Availability for Connection and Required Connection:

The waste water and sewerage system shall be "Available" for connection in accordance with District Rule 31-3.003(3) and Florida Statutes 381.0065(2)(a) when the Florida Department of Health releases the system for service, which is the date of actual "Availability". In accordance with Florida Statutes 381.00655, the affected property owners shall be required to connect to the sewerage system within one (1) year of the actual Availability.

Section 8. All Resolutions or parts of Resolutions in conflict herewith are hereby repealed to the extent of such conflict.

Section 9. In the event that any portion of this Resolution is found to be unconstitutional or improper, it shall be severed herefrom and shall not affect the validity of the remaining portions of this Resolution.

Section 10. This Resolution shall become effective upon its passage and adoption.

PASSED AND ADOPTED BY THE GOVERNING BOARD OF THE LOXAHATCHEE RIVER ENVIRONMENTAL CONTROL DISTRICT, THIS 21<sup>ST</sup> DAY OF JANUARY, 2016.

LOXAHATCHEE RIVER ENVIRONMENTAL CONTROL DISTRICT  
VOTE

\_\_\_\_\_  
STEPHEN ROCKOFF

\_\_\_\_\_  
GORDON M. BOGGIE

\_\_\_\_\_  
HARVEY M. SILVERMAN



\_\_\_\_\_  
JAMES D. SNYDER

\_\_\_\_\_  
DR. MATT H. ROSTOCK

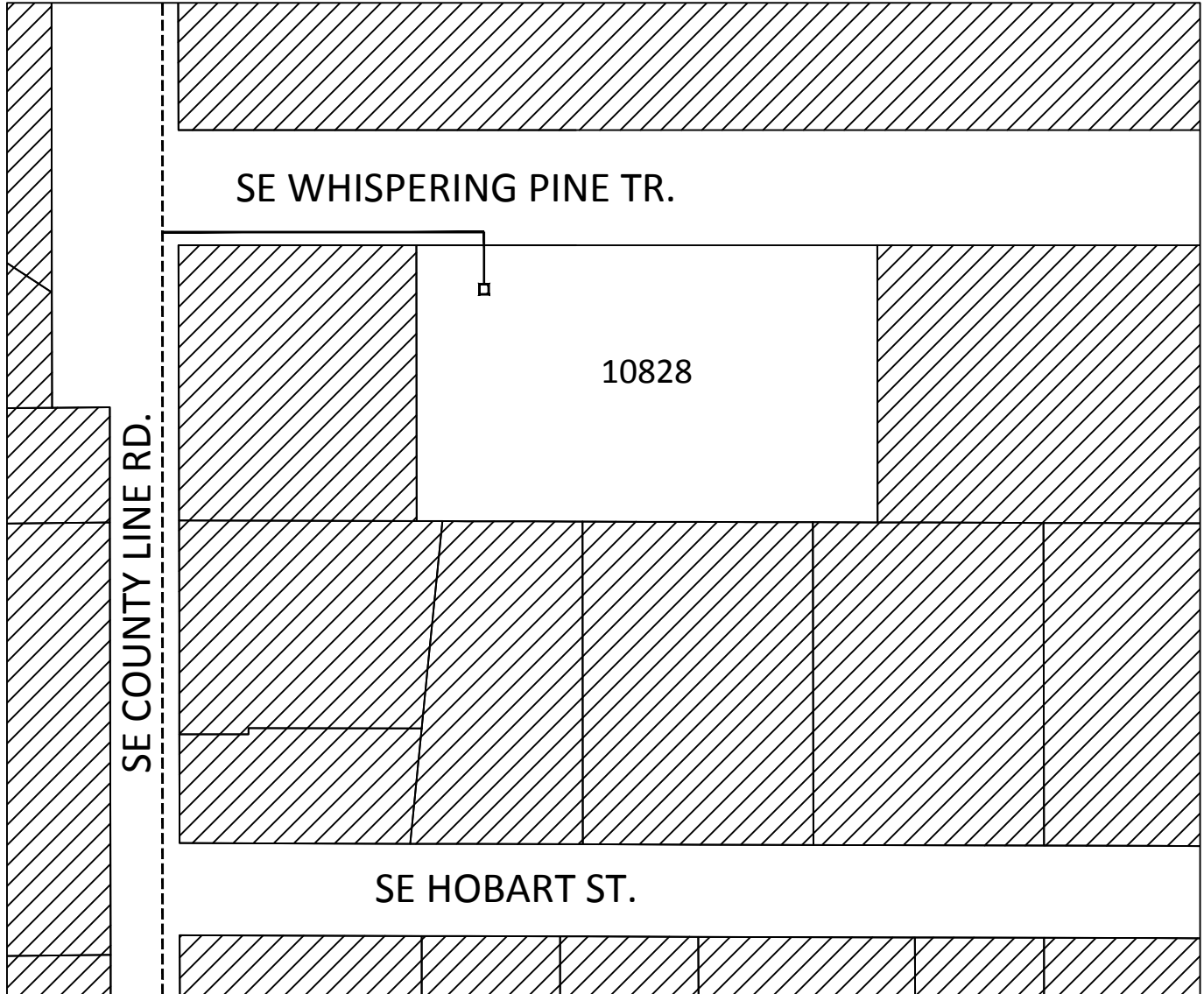
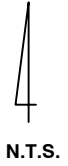
# EXHIBIT "B" WHISPERING PINES TR. SE SERVICES LOW PRESSURE SEWER SYSTEM ASSESSMENT AREA

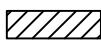
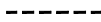

## LEGEND

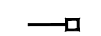
-  NOT IN ASSESSMENT AREA
-  EXISTING LP SEWER MAIN
-  PROPOSED LP SEWER MAIN
-  PROPOSED LP SEWER SERVICE

TEQUESTA, FLORIDA

## EXHIBIT “B”

### PROPOSED SEWER SERVICE ASSESSMENT AREA

#### **10828 WHISPERING PINES TRL. LOW PRESSURE ASSESSMENT AREA**

The property to be provided sewer service is located at 10828 Whispering Pines Trl. within Section 24, Township 40 South, Range 42 East, Unincorporated Martin County, Florida and lies within the following general boundaries:

PCN: 24-40-42-001-041-00030-5

On the North by Jonathan Dickinson State Park;  
On the South by S. E. Hobart St.  
On the East by Jonathan Dickinson State Park; and  
On the West by S. E. County Line Rd.

The approximate quantity of materials required to complete the project are:

150 Lineal Feet of Low Pressure Force Main  
1 Services  
1 Simplex Low Pressure Pumping Units

Mr. & Mrs. Jay Pitts

10828 SE Whispering Pines Trl

Tequesta FL 33469

re: 10828 SE Whispering Pines Trl

24-40-42-001-041-00030-5